



Image may differ from product. See the technical specification for details.

6301

Deep groove ball bearings

- Popular item
- SKF Explorer

[FIND A DISTRIBUTOR](#)

[View product table](#)

[Calculate](#) [↗](#)

[Mount and dismount](#) [↗](#)

[↑ TOP](#)

[TECHNICAL SPECIFICATION](#)

[CAD MODEL](#)

[MORE INFORMATION](#)

[MORE FROM SKF](#)

Technical specification

Display in: Metric Imperial

[↓ Technical Specification PDF](#)

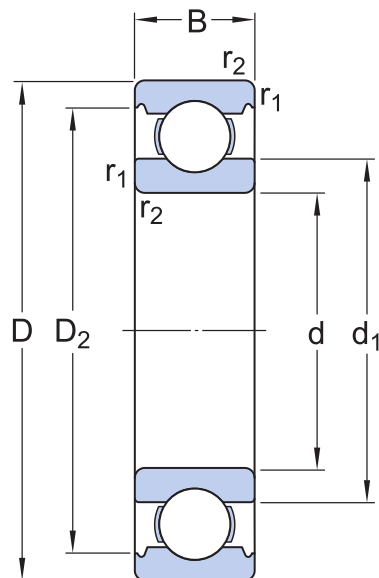

DIMENSIONS

d	12 mm	Bore diameter
D	37 mm	Outside diameter
B	12 mm	Width
d ₁	≈ 19.51 mm	Shoulder diameter
D ₂	≈ 31.48 mm	Recess diameter
r _{1,2}	min. 1 mm	Chamfer dimension

ABUTMENT DIMENSIONS

d _a	min. 17.6 mm	Diameter of shaft abutment
----------------	-----------------	----------------------------

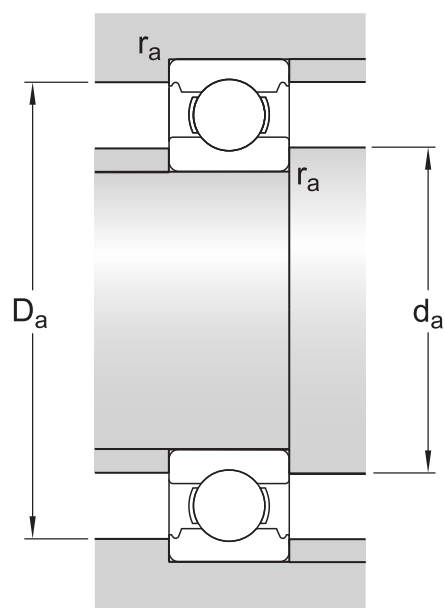

D_a	max. 31.4 mm	Diameter of housing abutment
r_a	max. 1 mm	Radius of shaft or housing fillet

CALCULATION DATA

Basic dynamic load rating	C	10.1 kN
Basic static load rating	C_0	4.15 kN
Fatigue load limit	P_u	0.176 kN
Reference speed		45 000 r/min
Limiting speed		28 000 r/min
Minimum load factor	k_r	0.03
Calculation factor	f_0	11

MASS

Mass bearing	0.06 kg
--------------	---------

TOLERANCE CLASS

Dimensional tolerances	P6
Radial run-out	P5

TOLERANCES AND CLEARANCES



BEARING DATA

- [Tolerances : Normal \(metric\)](#) , [P6](#) , [P5](#) , [Normal \(inch\)](#)
- [Radial internal clearance : Matched bearing pairs](#) , [Stainless steel d < 10 mm](#) , [Other bearings](#)

BEARING INTERFACES

- [Seat tolerances for standard conditions](#)
- [Tolerances and resultant fits](#)

More information

 Product details	 Engineering information	 Tools
Single row deep groove ball bearings	Principles of rolling bearing selection	Bearing_Select
Stainless steel deep groove ball bearings	General bearing knowledge	SimPro Quick
Single row deep groove ball bearings with filling slots	Bearing selection process	Engineering Calculator
Double row deep groove ball bearings	Bearing interfaces	LubeSelect for SKF greases
Bearing data	Seat tolerances for standard conditions	Heater selection tool
Loads	Selecting internal clearance	Rolling bearings mounting and dismounting instructions
Temperature limits	Lubrication	
Permissible speed	Sealing, mounting and dismounting	
Designation system	Bearing failure and how to prevent it	
		<div style="background-color: #334d5d; color: white; padding: 5px 15px; display: inline-block;">VIEW MORE</div>

More from SKF

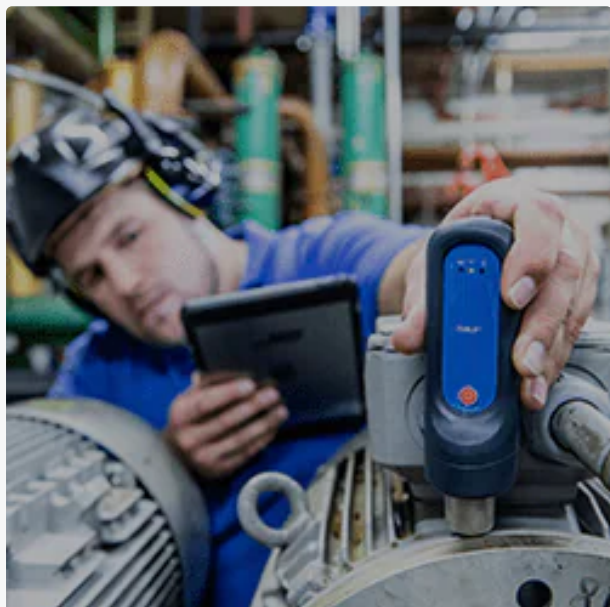

[Services](#)



[Lubrication management](#)

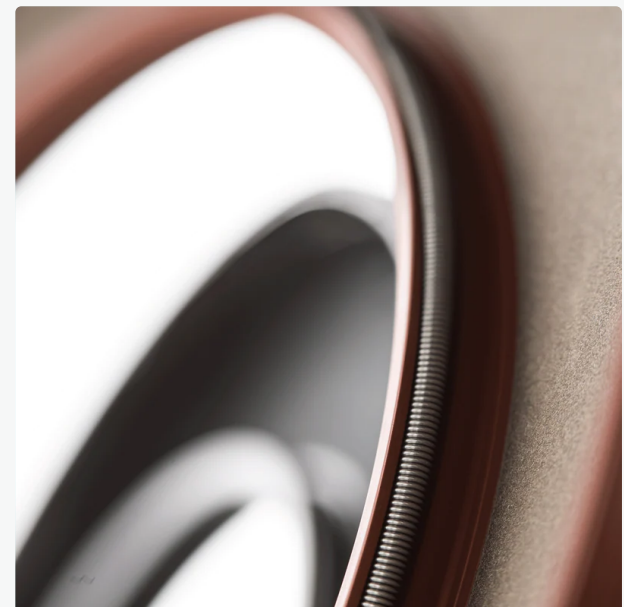

[Industrial seals](#)



[Maintenance](#)

ORGANISATION

[About SKF](#)

[Sustainability](#)

[Research and technology development](#)

[Brand protection](#)

[Supplier portal](#)

INVESTORS

[Investor relations](#)

CAREER

[Find a job](#)

[Why work at SKF?](#)

[Meet our people](#)

[Students and graduates](#)

SOCIAL NEWS AND MEDIA



[Press contacts](#)

[Magazines](#)

SKF IS ON



© Copyright

[Terms of use](#)

[Privacy policy](#)

[Site ownership](#)

[Cookies](#)

[General conditions of sales](#)

↑
BACK
TO TOP